



SOUND STORMWATER DESIGN

Copper Oaks Ct.
Muskego, WI 53150
414.286.4739
jayme.sisel@soundstormwater.com

CLIENT:
NEUMANN DEVELOPMENT, INC.

PROJECT TITLE:
WELSHIRE FARM DEVELOPMENT
GOLF ROAD
TOWN OF DELAFIELD, WISCONSIN

DATE: 02-03-23

JOB NO: 2023-003

SHEET TITLE:
POST-DEVELOPMENT CONDITIONS PLAN

FIGURE:

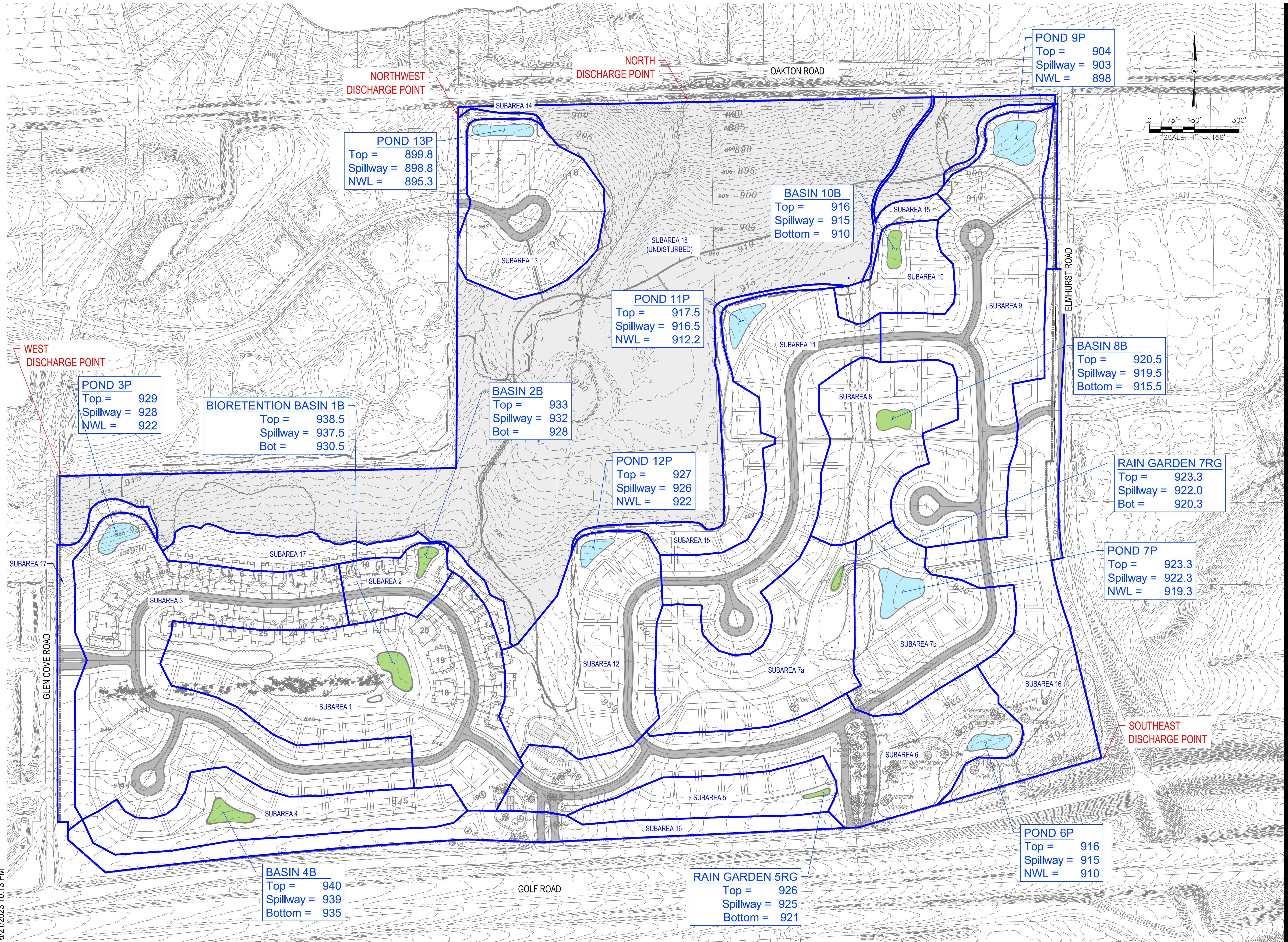

POND 9P
Top = 904
Spillway = 903
NWL = 898

POND 13P
Top = 899.8
Spillway = 898.8
NWL = 895.3

BASIN 10B
Top = 916
Spillway = 915
Bottom = 910

POND 11P
Top = 917.5
Spillway = 916.5
NWL = 912.2

BASIN 8B
Top = 920.5
Spillway = 919.5
Bottom = 915.5

POND 3P
Top = 929
Spillway = 928
NWL = 922

BIORETENTION BASIN 1B
Top = 938.5
Spillway = 937.5
Bot = 930.5

BASIN 2B
Top = 933
Spillway = 932
Bot = 928

POND 12P
Top = 927
Spillway = 926
NWL = 922

RAIN GARDEN 7RG
Top = 923.3
Spillway = 922.0
Bot = 920.3

POND 7P
Top = 923.3
Spillway = 922.3
NWL = 919.3

BASIN 4B
Top = 940
Spillway = 939
Bottom = 935

RAIN GARDEN 5RG
Top = 926
Spillway = 925
Bottom = 921

POND 6P
Top = 916
Spillway = 915
NWL = 910

D:\Jobs\2023\2023-003 - Thomas Farm - Welshire Farm - TRIO\CAD\Site.dwg\00\Proposed\2023-003
6/21/2023 10:13 PM