



- LEGEND:**
-  12 - PROPOSED BEDROCK PROBE LOCATION
  -  B-7 - EXISTING SOIL BORING LOCATION CONDUCTED ON 8/8/2007 BY PSI INC.

**SOILS LEGEND:**

Soil Description	Series	Hydrologic Soil Group	Potential Depth to Water	Potential Depth to Bedrock
HmB	Hochheim loam	D	>60"	>60"
HmC2	Hochheim loam	D	>60"	>60"
KwA	Knowles silt loam	C	>60"	20"-40"
KwB	Knowles silt loam	C	>60"	20"-40"
LmB	Lamartine silt loam	B/D	12"-24"	>60"
RkB	Ritchey silt loam	D	>60"	10"-20"
ThA	Theresa silt loam	C	>60"	>60"
ThB	Theresa silt loam	C	>60"	>60"
ThB2	Theresa silt loam	C	>60"	>60"
KIA	Kendall silt loam	C	12"-36"	>60"
BsA	Brookston silt loam	C/D	0"-20"	>60"



4100 N. CALHOUN ROAD  
 BROOKFIELD, WI 53005  
 PHONE: (262) 790-1480  
 FAX: (262) 790-1481  
 EMAIL: jpuedelko@trioeng.com

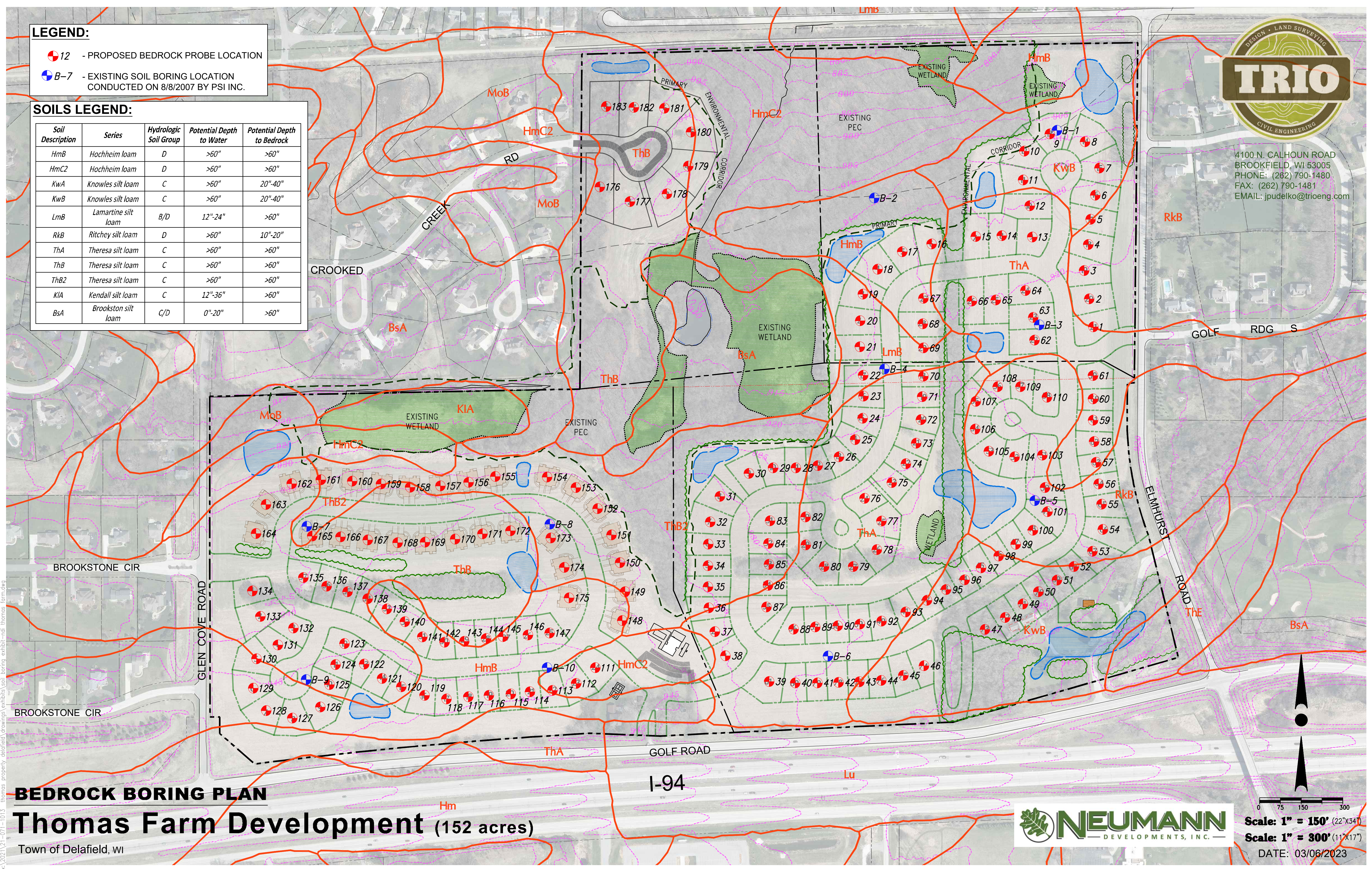

**BEDROCK BORING PLAN**  
**Thomas Farm Development (152 acres)**  
 Town of Delafield, WI



Scale: 1" = 150' (22"x34")  
 Scale: 1" = 300' (11"x17")  
 DATE: 03/06/2023

x:\2021\21-071-1013 - thomas property delineated drawings\exhibits\soil boring exhibit-rd1 thomas form.dwg